

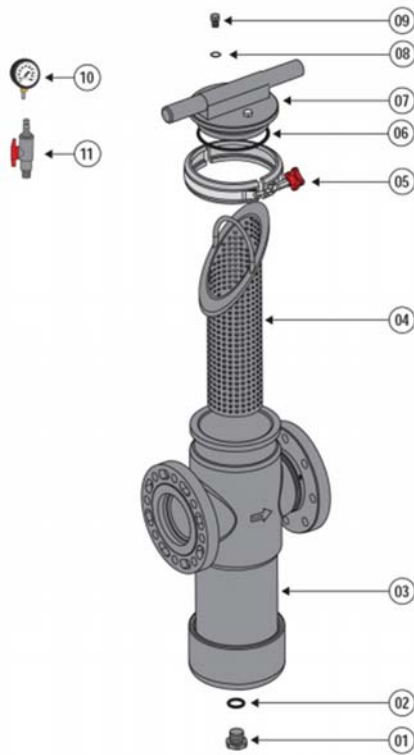

BP - BH

BASKET STRAINER – FLANGE & SOCKET ENDS PVC (BPF/S STRAINER) OR CPVC (BHF/S STRAINER) STRAINER



BILL OF MATERIALS		
ITEM	DESCRIPTION	Stainless Steel
1	Drain Plug	PVC/CPVC
2	Drain Plug o-ring	EPDM/FKM/PTFE
3	Body	PVC/CPVC
4	Strainer Basket	PVC/CPVC/316SS
5	Bonnet Clamp	316SS
6	Bonnet O-ring	EPDM/FKM/PTFE
7	Bonnet	PVC/CPVC
8	Plug O-ring	EPDM/FKM/PTFE
9	Gauge Port Plug	PVC/CPVC
10	Pressure Gauge	0-160 (1-1/4" & UP)
11	Pressure Relief Valve	0-160 (1-1/4" & UP)

SCREEN IS 8 MESH BY DEFAULT.
12, 20 AND 30 MESH ALSO AVAILABLE IN PVC/CPVC.
SMALLER MESH AVAILABLE IN STAINLESS. (CALL FACTORY)



PRESSURE / TEMPERATURE

RATING (NON-SHOCK)				
PVC		CPVC		
SIZE (in)	PRESS*	MAX TEMP	PRESS*	MAX TEMP
1/2 - 8	150 PSI	140 F	150 PSI	200 F
10-12	50 PSI	140 F	50 PSI	200 F

*PRESSURE AT 100 F
OIL FREE AIR HANDLING TO 25 PSIG MAX

Flanged Style

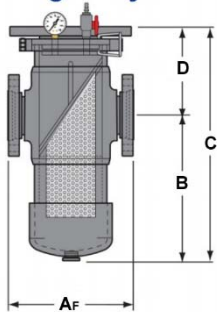

Socket Style

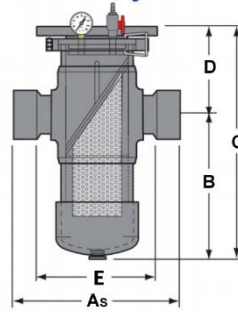

Spigot Style

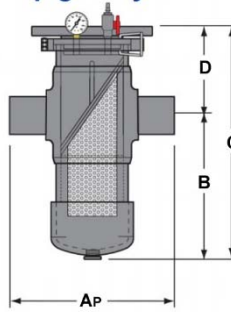

Basket Strainer sizes 1/2" though 1" bonnets are threaded cap with O-ring seal.

ENGINEERING SPECIFICATION

All thermoplastic Basket Strainers shall be fabricated from PVC Type I, ASTM D 1784 Cell Classification 12454 or CPVC Type IV, ASTM D 1784 Cell Classification 23447 material. All O-rings shall be EPDM or FKM. Strainer baskets shall be perforated PVC, CPVC, or type 316 stainless steel, or type 316 stainless steel wire mesh. Standard strainer perforations shall be 1/8" or 3/32" with a minimum open area ratio of 6:1, or specified perforation/mesh

DIMENSIONS (in) / PERFORMANCE

SIZE	A _F	A _S	A _P	B	C	D	E	C _v	W/t. (lb)	
									FLANGED	SOC/SPIG
1/2	9-1/4	6-3/4	9-9/16	5-5/8	10-1/8	4-1/2	5-1/4	4.5	3.4	2.97
3/4	9-1/4	6-7/16	9-7/16	5-5/8	10-1/8	4-1/2	4-7/16	10.0	3.4	2.99
1	10-3/8	6-13/16	10-1/16	5-5/8	10-1/8	4-1/2	4-1/2	15.0	3.5	3.02
1-1/4	8-3/16	11-5/16	10-5/16	10-1/4	18-1/4	8	8-5/16	30.0	3.6	3.20
1-1/2	8-3/4	11-1/8	11	10-1/4	18-1/4	8	8-1/8	46.0	3.8	3.50
2	8-3/4	12-1/8	11	10-1/4	18-1/4	8	8-5/8	72.0	11.4	11.00
2-1/2	8-3/4	12-3/8	12-7/8	10-1/4	18-1/4	8	8-3/8	110.0	12.6	12.30
3	11-5/8	16-1/8	15	13-13/16	22-9/16	8-3/4	11-5/8	172.0	25.4	25.00
4	12	18	17-1/2	17-5/16	26-1/16	8-3/4	13-1/2	270.0	26.8	25.70
6	17-1/8	24-3/8	23-5/16	18-7/8	29-7/16	10-9/16	17-7/8	630.0	60.8	58.40
8	20-1/2	30-1/2	27-1/2	24-1/2	36-1/16	11-9/16	22	750.0	96.0	93.60
10	26	34-9/16	34-1/2	27-1/8	43-3/4	16-5/8	24-1/16	893.0	210.0	200.20
12	28-1/8	39-3/16	36-1/4	34-5/16	51-1/2	17-1/8	26-11/16	1063.0	239.8	229.30