



DUPLEX STRAINERS

INSTALLATION & MAINTENANCE INSTRUCTIONS

INSTALLATION

Duplex strainers are installed where fluid flow cannot be interrupted while the basket is removed for cleaning. Before installing the duplex strainer, ensure the pressure rating, end connections, and material are suitable for the system. The machined surfaces should be free of defects, and the inside of the strainer free of foreign objects. The piping should be straight, and not at an offset or rotated.

Strainers should be installed with the arrow on the strainer body pointing in the direction of flow.

Duplex strainers should be installed in horizontal pipelines only, and the screen chamber must be pointing downward. Basket strainers are most commonly used for liquid service applications.

If flanged, ensure the flanges of the mating flanges on the piping are aligned with the strainer flanges, so that no undue stress is put on the strainer or pipe when tightening the bolts. Tighten the bolts gradually in a crossing pattern until all bolts are tight. If threaded, use appropriate sealant on the threads.

The system can be slowly pressurized while checking for any leakage around all connections. Depressurize the system and start the installation procedure over if there is any leakage.

A differential pressure gauge installed across the inlet and outlet of the strainer is helpful to indicate pressure loss due to clogging, which can indicate when cleaning is required. Normally when the differential pressure reaches 5-10psi, the screen should be cleaned.

MAINTENANCE

 **WARNING:** Before loosening of any bushing, cap, plug, or cover on a strainer, extreme caution should be exercised to ensure there is zero pounds pressure in the system. Only after the system has been depressurized should the strainer be drained for service. **SERVICE ON A PRESSURIZED STRAINER CAN CAUSE SERIOUS INJURY OR PROPERTY DAMAGE.**

Centering the position of the handle (as shown) allows for flow to both chambers. Rotating handle to the far right or left diverts the flow to the chamber UNDER the handle. This allows for cleaning of the basket not in use. Remove basket well covers by turning knobs to release yokes clear of the covers.

After carefully removing a screen, it should be brushed and/or soaked in a cleaning solution and/or cleaned using a brush. Trapped material in the screen should not be allowed to harden, and a regular cleaning schedule will avoid clogged screens. Extra screens can be useful in keeping the system operating during the cleaning process.

See the following page for an exploded parts list.

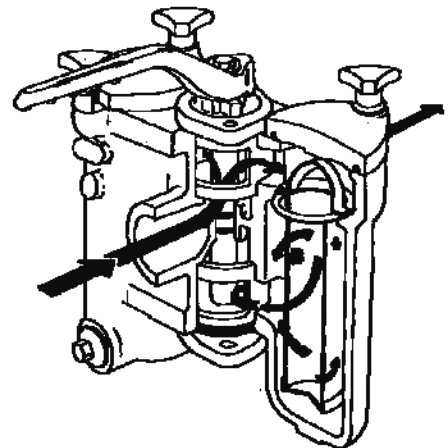

PARTS LIST

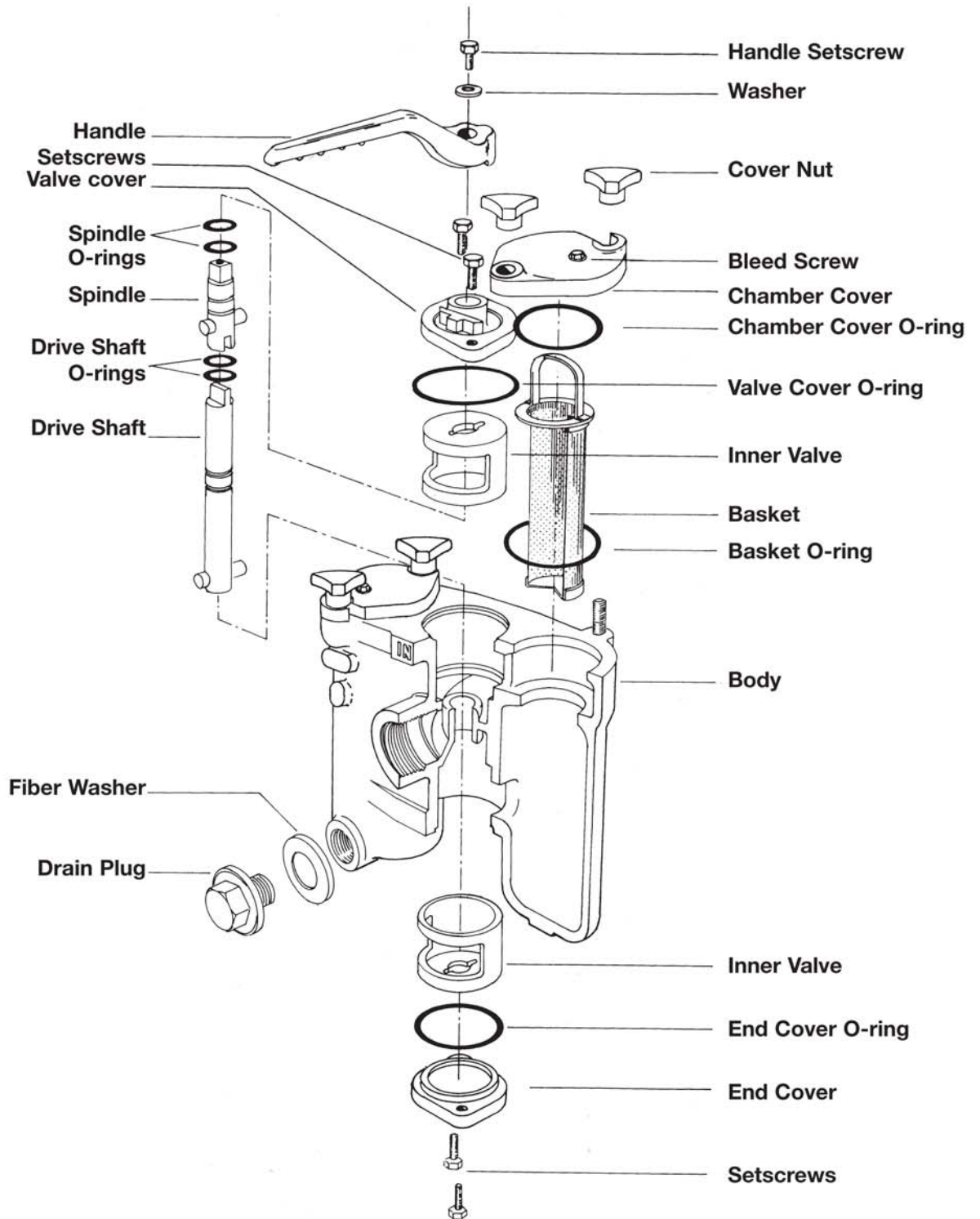

5" & 6" Size - Four basket design not shown.
 8" Size - Bolted cover.